

G5j

STEICOjoist to STEICOjoist connection (3 Ply)

Filler Blocks to be fitted as detail G8.
Backerless hanger should be installed in
line with manufacturers guidance.

3 Ply i-joist connected
using 2 no. min.600mm
long Filler blocks
positioned between each
ply centrally at incoming
member

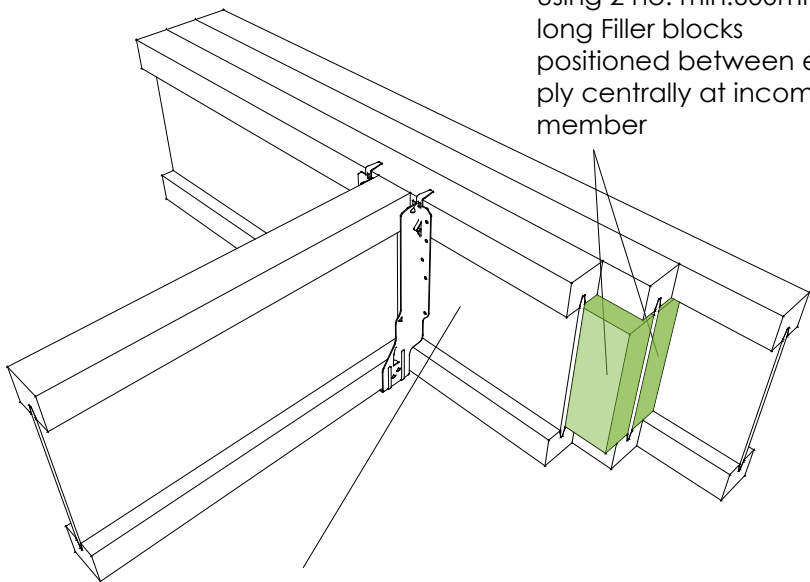

No Backer blocks required.