

G5k

## STEICOjoist to STEICOjoist connection (3 Ply)

Filler Blocks to be fitted as detail G8.  
Web stiffeners to be fitted as detail G6.  
Joist hanger installed in line with  
manufacturers guidance.

3 Ply i-joist connected  
using 2 no. min.600mm  
long Filler blocks  
positioned between each  
ply centrally at incoming  
member

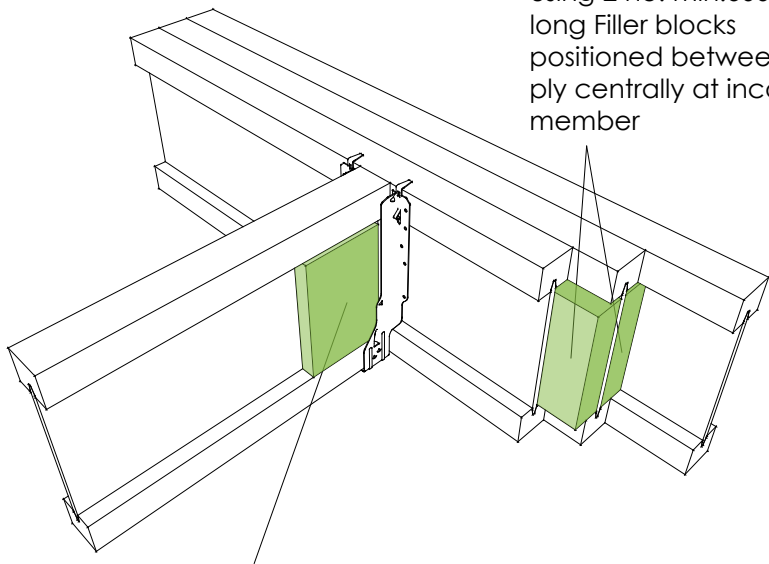

Web stiffeners required.