

R4b

Bevelled wallplate at eaves

STEICOjoist or
STEICO LVL blocking

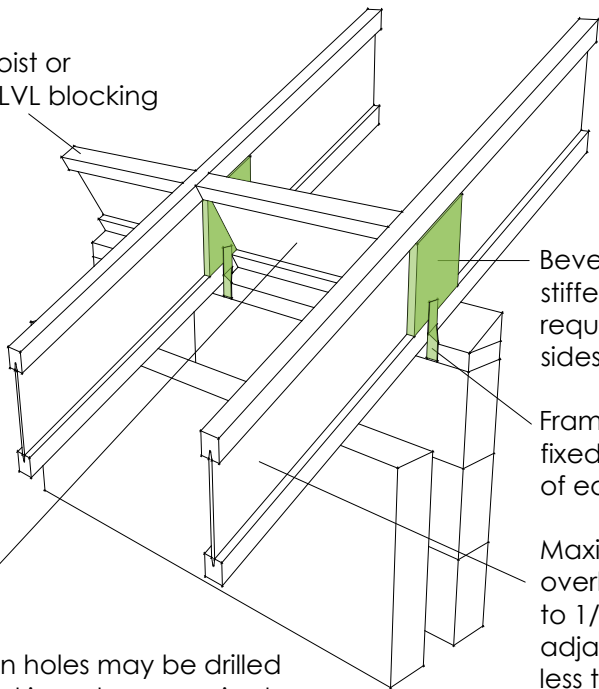

Bevelled web
stiffener may be
required both
sides

Framing anchors
fixed to both sides
of each joist

Maximum
overhang limited
to 1/3 of the
adjacent span or
less than 600mm

Ventilation holes may be drilled
in the blocking where required