

Joists parallel to party wall

Overall minimum thickness of solid section rimboard and joist to be 76mm

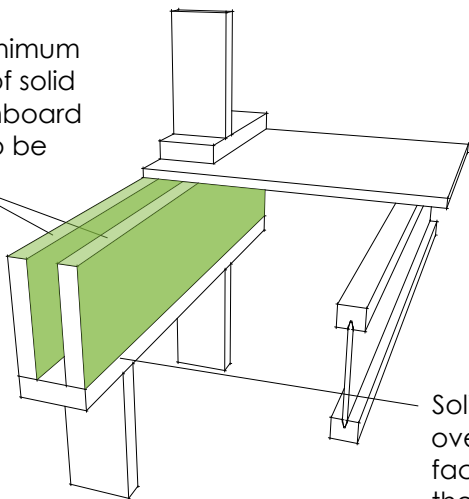

Solid section joist may overhang the inside face of the wall by half the blocking width

Minimum nailing for class 1 structures to be 3.00*75 nails at 300mm centers which should be applied at each interface where lateral loads are to be transferred. Refer to STA "Design Guidance on Disproportionate Collapse" for further information