

Handling instruction

STEICO*flex*





STEICOflex

Better insulation, naturally.

STEICOflex insulation mats are made from natural softwood, which gives them all the benefits that wood offers as a natural construction material. STEICOflex is the ideal insulation for anyone wishing to combine high technology with building sustainably and protecting the climate.

STEICO uses only wood sourced responsibly through forestry certified by the PEFC (Programme for the Endorsement of Forest Certification Schemes). It imposes stringent requirements on forestry businesses in terms of sustainability, environmentally friendly forest management, work quality and social responsibility. Furthermore, STEICO products bear the quality seal of the IBR (Institut für Baubiologie Rosenheim), which is a testament to their environmental credentials.



The information in this brochure applies to STEICOflex 036 and STEICOflex 038 wood fibre insulation. For simplicity's sake, they are generally referred to as STEICOflex.



Application areas

STEICOflex – the flexible wood fibre insulation mat

The flexible and vapour-permeable wood fibre insulation mat is equally suited to cavities in roof, wall and ceiling structures and to cavity insulation in partition walls, facing formwork and installation levels.

STEICOflex is highly compressible. It is installed dry and will not resist compression. STEICOflex is produced and monitored in accordance with the EN 13171 standard.



1	Cavity insulation between rafters and ceiling beams	
2	Insulation below rafters, suspending ceiling etc. cavity insulation to timber-frame and timber-panel construction	
3	Insulation to walls and partitions	

National standards and regulations must be observed

Handling

Installing STEICOflex properly

When handling STEICOflex inside the building shell, you will need an airtight layer and a vapour barrier layer on the inside and a driving rain and wind seal on the outside (see also 'STEICOMulti sealing system') product overview. The planner should verify that STEICOflex has been used correctly.

Cavities fitted with STEICOflex should be sealed after four weeks at the most to prevent damage to the insulation. STEICOflex must be protected from moisture at all times. If STEICOflex is installed in exterior structures during cold weather, it is important to fit the necessary vapour barrier

and apply an airtight seal to it immediately after installation. This will prevent moisture from penetrating the thermal insulation and other structural layers from the interior.

In the case of variable-moisture vapour barrier sheets such as STEICOMulti renova, vapour diffusion resistance will reduce at high relative humidity. This is particularly important to note when construction moisture (interior plastering, liquid screed) increases on building sites in winter.

Storage and transport

Do's and don'ts

- Do not remove transport packaging until the pallet is on solid and level ground
- Do not place anything on top of stored pallets
- Do not place any significant loads on insulation packaging when it is in storage or being transported
- Store STEICOflex in a dry place
- Retain pallet inserts and packing labels for your construction site records



Cutting

STEICOflex can be cut easily with an insulation knife, a reciprocating saw, a jigsaw or any power hand saw with two reciprocating serrated blades.

STEICOflex produces very little dust when handled and is gentle on skin.

STEICOisoflex cut combi – the cutting table

In the case of frequent insulation work and to improve cutting precision, a power saw can be set up on a special cutting table: the STEICOisoflex cut combi. The precise positioning means that there is no need to keep calibrating the desired insulation width over and over again. The cutting operations are kept parallel, and it is possible to cut at precise angles.

The STEICOisoflex cut combi cutting table can easily be transported to the required location on standard castors, which makes it flexible and time-saving for on-site production of elements for walls, ceilings and roofs.

STEICOisoflex cut combi is available as part of our product range. Please ask your specialist dealer whether equipment is available for hire. See page 6 for other cutting equipment.



Safe handling



Cutting at precise angles

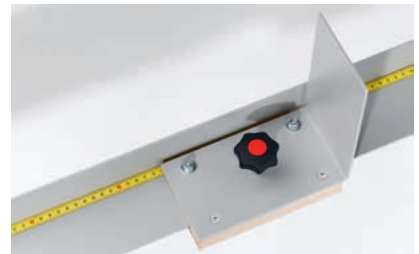

Accurate width settings

Cutting equipment

Cutting devices	Accessories	Notes
<p>Bosch GFZ 16-35 AC</p> 	<p>TF 350 WM double serrated blade set</p>	<p>–</p>
<p>Dewalt DWE396, DWE397, DWE398, DWE399</p> 	<p>DT2979-QZ serrated blade set</p>	<p>–</p>
<p>Mafell DSS 300 cc wire insulation saw</p> 	<p>ST 1700 Vario saw workbench S 200 high-capacity extractor</p>	<p>Max. cutting depth: 300 mm Cutting depth of 140 mm when swivelled 60° Fibre extraction and vacuum cleaner recommended</p>
<p>Jigsaw</p> 	<p>Bosch T 1013 AWP jigsaw blade</p> 	<p>Good cutting quality up to an insulation thickness of 160 mm Vacuum cleaner recommended</p>
	<p>Bosch T 313 AW jigsaw blade</p> 	<p>Maximum insulation thickness: 100 mm Vacuum cleaner recommended</p>
<p>Festool</p> 	<p>ISC 240 EB cordless insulation saw (cutting set: SG-240 / W-ISC)</p>	<p>Max. cutting depth: 240 mm Larger cutting depths with cutting set SG-350/W-ISC</p>
<p>STEICO insulation knife</p> 	<p>–</p>	<p>Serrated knife for small surfaces and tidying up</p>
<p>BAHCO ProfCut PC-22-INS</p> 	<p>–</p>	<p>For small surfaces Max. cutting depth: 180 mm</p>
<p>Circular saw</p>	<p>Coarse saw blade</p>	<p>Vacuum cleaner recommended</p>

Installation with oversize to assist friction fitting

STEICOflex is installed slightly longer and wider than it needs to be. This ensures that STEICOflex can be friction-fitted in the cavity. The oversize to assist friction fitting in the cavity measures approximately 10 mm. The wood fibre insulation mat clings snugly in place in the cavity and will retain its shape there permanently.

The oversize to assist friction fitting depends on the insulation thickness, the rafter spacing, the roughness of the rafters and the roof pitch.

The maximum insulation thickness corresponds to the rafter height/stud depth.

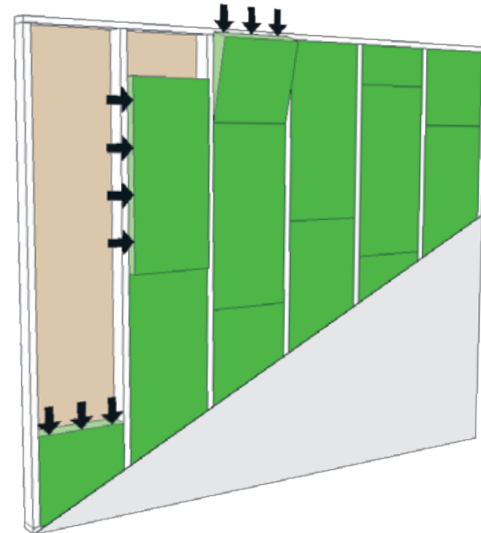

The following maximum span widths can be applied to the horizontal ceiling area:

Insulation thickness [mm]	Maximum span width [mm]
40 - 60	450
70 - 80	550
90 - 100	600
120	650
140 - 150	700
160 - 170	750
180 - 190	800
200 - 240	850

Greater widths are possible for installation at inclines and in walls. STEICOflex wood fibre insulation mats fitted horizontally need to be secured to prevent them from falling out immediately after installation.

Suitable action should be taken to surround the edges of the cavities at storey height – 3.5 metres at most.



It is possible to fill large gaps by laying the mats on their sides. To avoid waste, you can take the remainder of a mat and push it into the cavity together with a new mat.
= CONTINUOUS INSTALLATION

General information

Safety

Cutting and handling the flexible STEICOflex wood fibre insulation mats will produce dust. You should wear a commercially available dust mask when working overhead with STEICOflex. Observe all national regulations regarding working with wood dust.

Maximum temperatures

Installed elements such as ceiling spotlights with surface temperatures of more than 100 °C must not come into direct contact with STEICOflex. It may be necessary to enclose fittings.

Disposal

The disposal is regulated by European waste code ewc, 030105 and 170201, meaning that it is to be disposed of in the same way as wood and timber products. Observe all national regulations regarding disposal.

Responsible for content

STEICO SE
Otto-Lilienthal-Ring 30
85622 Feldkirchen
Germany
Web: www.steico.com
Mail: info@steico.com

The contents of this document have been prepared with the utmost care. However, applicable regulations can change. STEICO accepts no liability for the accuracy, completeness, or current applicability of the content. Application areas may vary in the detailing. Always verify the suitability of our products for the specific intended use.

The contents of this document have been prepared in consideration of European product standards and provide a general overview of component structures, construction methods, and installation. National applicable regulations have not been considered. Before using our products, please verify that the applicable national regulations for the specific area of use are followed.

Version: 1

Date: 2025-06-03

The currently valid version can be found at:
steico.com/hi_flex_eur_en

